



WARNING!

1.877.FASTOYS

TRINITY RACING DOES NOT TAKE RESPONSIBILITY FOR DAMAGES THAT MAY OCCUR DURING OPERATION OF YOUR VEHICLE UNDER IMPROPER JET SETTINGS. IT IS THE FINAL RESPONSIBILITY OF THE OWNER/RIDER TO ADJUST JETTING TO SPECIFIC RIDING CONDITIONS AND ELEVATION BEFORE RIDING

PLEASE FOLLOW ALL OF THESE INSTRUCTIONS CAREFULLY.

KFX450 POWERFLOW INSTRUCTIONS

PARTS AND INSTALLATION PROCEDURE

1. Remove the lid and filter, airbox, and the sensor that attaches to the airbox using a Phillips screwdriver. Also remove the air intake boot that goes from the airbox to the throttle body.
2. Once you have the airbox removed, Take a flat blade screwdriver and pry the plastic inlet off of the airbox. This is done by twisting the screwdriver's large flat blade from the inside of the inlet at 12, 3, 6, and 9 o'clock positions. The plastic inlet will pop off after applying this pressure.
3. Once the inlet is out you will have to trim the inside of the airbox to fit your new Trinity Racing powerflow intake adaptor. This can be done with a dermal tool or a jig saw. It doesn't have to be perfect as the adapter seals off external air from both sides.
4. Once you have the adaptor going through the hole as shown, hold the adaptor to the airbox with the logo up and mark the three mounting holes using a sharpie. As you will see they go right through the center of the groove in the box. Then using a 15/64" or 6mm drill bit drill the three holes for the adaptor.

Once drilled install the adaptor with the supplied hardware.

Clean and re-install the airbox, sensor, air inlet tube and new filter with outerwear securely, and you are done.

THANK YOU FOR YOUR BUSINESS. HAVE A FUN AND SAFE RIDE!

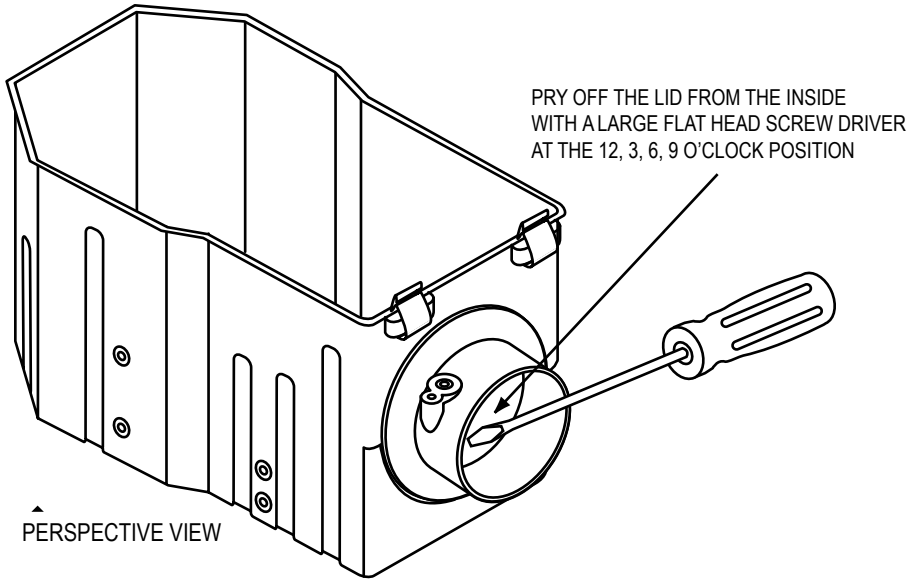

PERSPECTIVE VIEW

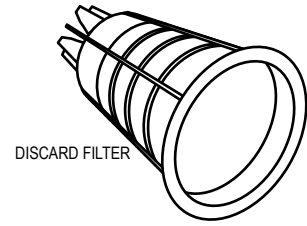

DISCARD FILTER

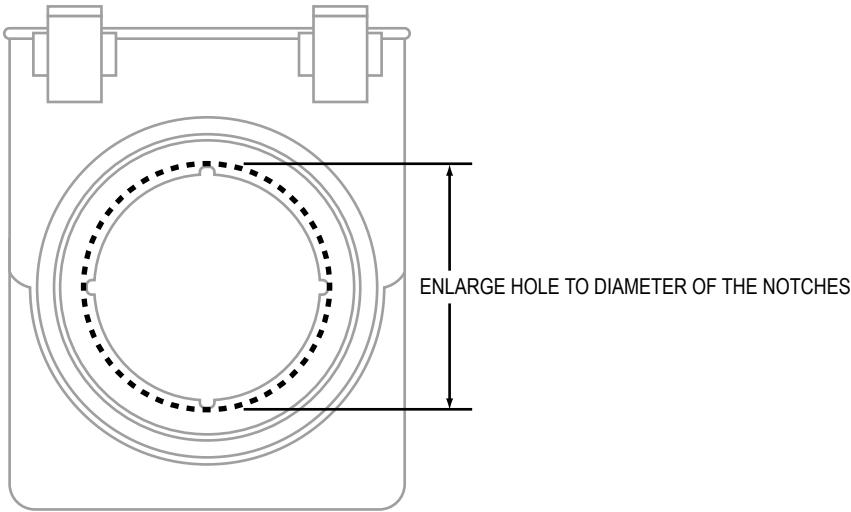

FRONT VIEW

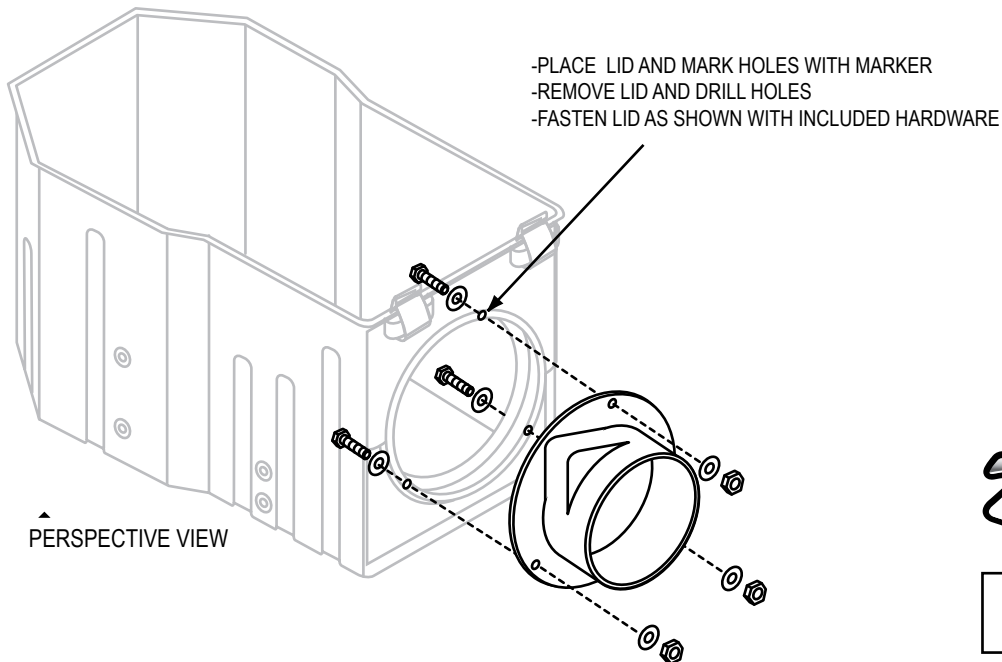

PERSPECTIVE VIEW



FOR FURTHER ASSISTANCE CALL
909.373.1337